

## CARE & MAINTENANCE OF NATIONAL HICKMAN DOORKITS

Doors are supplied factory finished and edge banded 2 long edges. Periodically, they must be cleaned with a soft duster or dampened cloth containing a non-abrasive detergent.

### HINGES

Wipe all surfaces with a clean cloth. Do not use abrasive detergents. Ensure fixings are secure and lubricate twice per year with light lubricating oil, such as 3 in 1 to the hinge pin washers (as per diagram).

Wipe away any excess lubricant with a dry cloth or tissue. Open & close the door several times to aid lubrication.

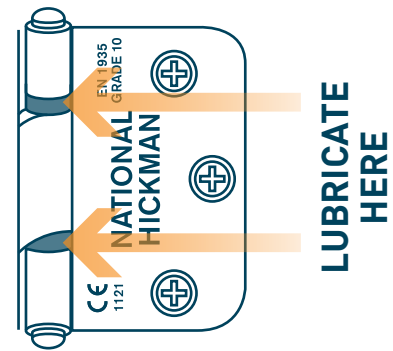

### LOCKS AND LATCHES

Wipe all surfaces with a clean cloth. Do not use abrasive detergents. All moving parts should be lightly lubricated twice per year.

To lubricate the lock, retract the latch by depressing the handle.

Apply light lubricating oil such as 3 in 1, in the opening created between the fore-end of the lock and the angled side of the latch. Operate the mechanism a number of times to distribute the lubricant.

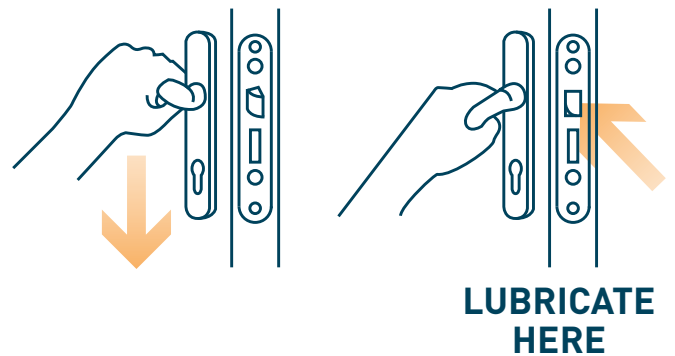

# FIRE DOORS

Just like any passive or active fire protection system, it is essential for a fire door to perform its vital task in the event of a fire. As with any life-saving product, a fire door should be regularly checked to ensure it functions properly and is ready to use. It is exactly the same as testing the battery of a smoke alarm or having the pressure of a fire extinguisher checked regularly.

Most of the time, a fire door is used like any other door, and is subject to the day-to-day wear and tear of opening and closing as people pass through it. The building and surrounding environment can also change and affect the door. It is important to check if regular use or changes to the surroundings, have affected it in any way.

Any slight alteration to the door or its surroundings can affect the performance of the door. This can result in a half hour fire door lasting a lot less. So, once a fire door has been installed correctly, it needs to be maintained regularly to ensure that everything is in working order. Periodic checks should be carried out at least once every six months. Newly occupied buildings may require more frequent checks in the first year of use.



# CERTIFICATION

Every Fire door design manufactured under the BWF-CERTIFIRE scheme has been independently tested and certificated as proof that, all things being equal it will be reliable in the event of a fire. In new buildings, heating should be introduced gradually and over a reasonable period.

# CHECK LIST

- Door & Frame: Check that the leaf is square in the frame and has not distorted. (Check that the gaps are even all around the door)
- Damage: Minor facial damage can be repaired; however any major defects may necessitate total replacement.
- Intumescent Seals: Badly fitted or damaged seals must be replaced. They must be the same type as originally fitted.

# CAUTION!

DOORS ARE HEAVY – Particular attention must be given to product weights before handling to ensure the safety of the user.

# GLAZED DOORKITS

All glazed panels are toughened safety glass in accordance with EN 12150-2 (2004).

